

CHARLES W. EISEMANN CENTER

FOR PERFORMING ARTS AND CORPORATE PRESENTATIONS

2351 Performance Drive, Richardson, TX, 75082 972/744-4600

BANK OF AMERICA HALL

Meetings-Banquets-Receptions

Revision
18

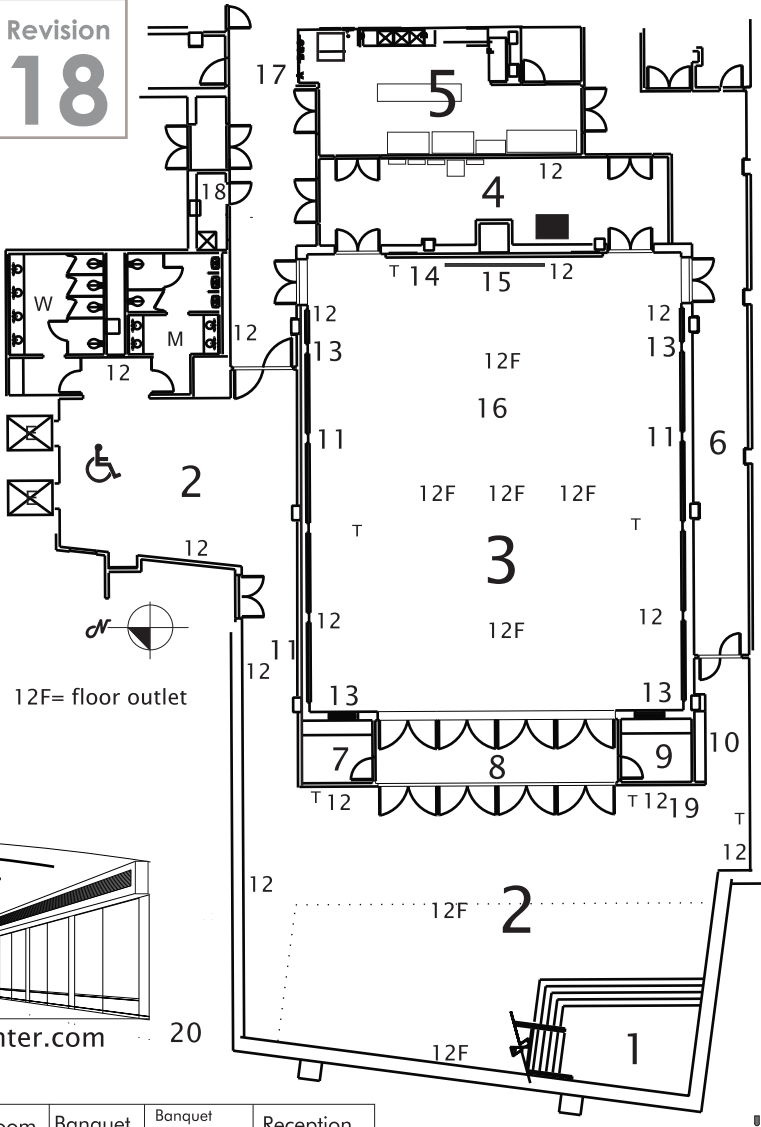

12F= floor outlet

Lighting

- Control: ETC Smart Fade Dimmer board with Unison wall controls
- 30 ETC Sensor Dimmers
- LED RGB ceiling accent uplights
- 8 - ETC Panels 375w.
- 30 - 375 watt ultra wide par ceiling lights (fix focus, they may not be altered)

Sound

- Mixing Console: Behringer Digital X32
- QSC Q-SYS audio processor network
- Renkus-Heinz speakers w/McCauley AC-588 Subwoofer
- QSC CX Amplifiers
- 1-Tannoy T112 Monitors
- FM - Assisted Hearing System
- House Mix Position in rear of room
- 2 CD Players
- 2 wired microphones included
- 6 channels of Shure Wireless Mics

Video

- 1- Optoma WU515T Multimedia Projector 5000 ANSI Lumens,
 - 7'-6"X10' Stewart Model "A" Screen
 - Computer interface to projector HDMI interface
- Maximum resolution: WXUGA 1920 x 1200

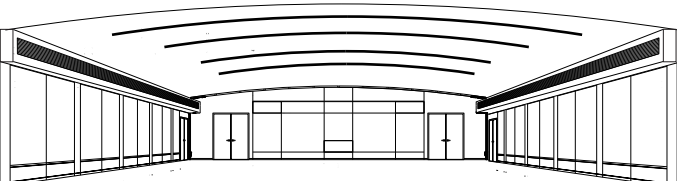

See the room in color at eisemanncenter.com

Room Statistics

Sq.Ft.	Dimensions	Ceiling Ht.	Theater	Classroom	Banquet	Banquet w/Dance Fl.	Reception
3,150	50'X63'	10'7" -12'-5"	300	180	200	170	300*

* Includes TXU Lobby

Map Legend

- | | | | | |
|-------------------|-------------------------|----------------------|--------------------------------|-------------------------------|
| E= Elevator | 1. Grand Stair Landing | 6. Service Hallway | 11. Broadcast Panel | 16. Video Projector |
| M W = Rest Rooms | 2. TXU Lobby | 7. Control Room | 12. 20a./120v. Electric outlet | 17. Hall to catering elevator |
| T= Telephone Jack | 3. Bank of America Hall | 8. Sound Lock | 13. 20a/3ph Electric outlet | 18. Mop/sink room |
| | 4. Chair Storage | 9. Tech Support Room | 14. AV Connection Panel | 19. 32"video monitor |
| | 5. Prep Kitchen | 10. Pay Phone | 15. Projection screen | |

Hospitality Equipment Inventory

- 24 2x2 Lights
- 30 4' Lights
- 30 6' Lights
- 48 8' Lights
- 60 10' Lights
- 60 12' Lights
- 60 14' Lights
- 60 16' Lights
- 60 18' Lights
- 60 20' Lights
- 8' Table
- 6' Table
- 4' Table
- 2' Table
- 2' Table
- 2' Table
- 2' Table
- 2' Table
- 2' Table
- 2' Table

White Table Linen & Black Skirting available for an additional cost.

4X8'



15' X15'

Dallas Area Rapid Transit
DART Station

www.dart.org

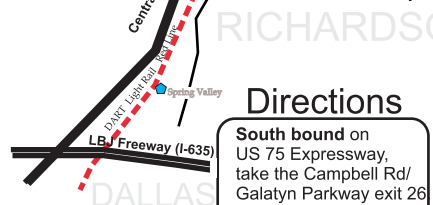

Directions

South bound on US 75 Expressway, take the Campbell Rd/ Galatyn Parkway exit 26 Turn left onto overpass that becomes Galatyn Parkway, then left on Performance Drive.

North bound on US 75 Expressway, take the Renner Rd/ Galatyn Parkway exit 27A. Turn right onto Galatyn Parkway, then left on Performance Drive.

Note: clients are reminded that the lighting and sound inventory is provided as a courtesy at no additional charge.

Every effort is made to keep our equipment in good working order. However, some equipment may not be available every time. Designers are asked to allow 10% for loss or repair. Inventory numbers are a guideline not a guarantee.

Justice Rev 10.31.19